



## DFS200 Defibrillator / AED Handheld Tester

The defibrillator tester comes with various ECG patterns for AED defibrillation tests and an embedded battery voltage multimeter

- Paired with its dedicated APP to assist users in effortlessly configuring and testing with intuitive operations
- Provides a variety of ECG waveforms to assess AED's analysis capability
- Embedded multimeter for AED battery voltage measurement
- Configurable defibrillation energy criteria separately for adult and pediatric modes to ensure AED meets the manufacturer's specifications
- Automatically saves test data, including shock energy (in Joules) and waveforms, battery voltage, and dates, to establish a test history
- Supports standalone operations for simple tests
- Optional PC software — displays shock energy and waveforms on one screen, and allows users to store customized waveforms and set commonly used ECG signals for standalone operations, benefiting the QA department by rapidly verifying AED performance

## • Energy Measurement Specifications

Items	Specifications
Maximum Energy	Range : Up to 600J
Voltage	Range : Up to 5000Vp Accuracy : $\pm$ (1% of reading + 2V), typical
Load Resistance	Resistance : 50 $\Omega$
Pulse Width	Range : 1.0 – 50.0ms Accuracy : $\pm$ 0.1ms
Maximum Average Power	12W, equivalent to 1 defib pulse of 360J every 30 seconds
Battery Level (AED Battery)	Measurement Voltage : 0.40 – 40.00V Accuracy : $\pm$ 0.05V for 5.00 – 40.00V
Battery Level (AED Battery, measured with 200mA load)	Measurement Voltage : 3.60 – 40.00V Accuracy : $\pm$ 0.5V for 3.60 – 40.00V

## • Compliance Specifications

Items	Specifications
Safety Standards	CE : IEC / EN61010-1:2010+A1:2016; Pollution degree 2 61010-2-030:2017
Electromagnetic Compatibility Standards (EMC)	CE : EN61326-1; EN301489-1 / EN301489-17; FCC : EMC P15B
Other Standards	CE : RF EN 300328; EN62311; NCC : RF LP0002

\* Specifications are subject to change without prior notice.

## • General Specifications

Items	Specifications
Temperature	Operating : 0°C – 50°C (32°F – 122°F) Storage : -20°C – +60°C (-4°F – +140°F)
Humidity	10% - 90% non-condensing
Communications	Wireless (Low Energy Radio) USB Type-C connector
Operation Modes	Remote (APP)
Power	9V alkaline battery x 1 Battery level display & low power alert on APP
Mechanical	Housing : ABS Plastic Size (L x W x H) : 17.0cm x 8.55cm x 4.0cm Weight : 330g

## • DFS200 Test System

Part No.	Description	Quantity
100-DF00107	Model No.: DFS200 Model Name: Defibrillator / AED Handheld Tester	1

## • Optional Accessories

Part No.	Description	Quantity
G34-0600101	DFS carrying bag	1
D06-9000321	9V alkaline battery	1
K22-0500101 *	Open-ended AED cable (Banana Male), 0.5 meter (Black)	1
K22-0500102 *	Open-ended AED cable (Banana Male), 0.5 meter (Red)	1
300-DFBMPLD	Battery measurement probe with load	1
K29-0900501	Battery measurement probe	1
N61-0210033	Compact splicing connector	1
K27-1800304	USB transfer cable: Type-A to Type-C (Male to Male), 1.8 meter	1

\*Note: Customization of AED interface cable adapter is available. Please contact WhaleTeq (service@whaleteq.com).

## • Optional Paddle Box Set

Part No.	Description	Quantity
300-DFPD0CK	DFS tester docking base for defibrillator	1
E13-070P101	DFS tester defibrillation receiving plate	2

## • Optional Software

Part No.	Description
HE0-DF00003	DFS200 PC software

## • Optional Calibration Service and Warranty Extension

Part No.	Description
YY0007	Model No.: C3 Provides (3) years of calibration service coverage. WhaleTeq equipment can be calibrated to original performance on the basis of (1) year interval.
YY0008	Model No.: R3 Extends the limited warranty from (1) year to (3) years.

## • AED Testing Scenario

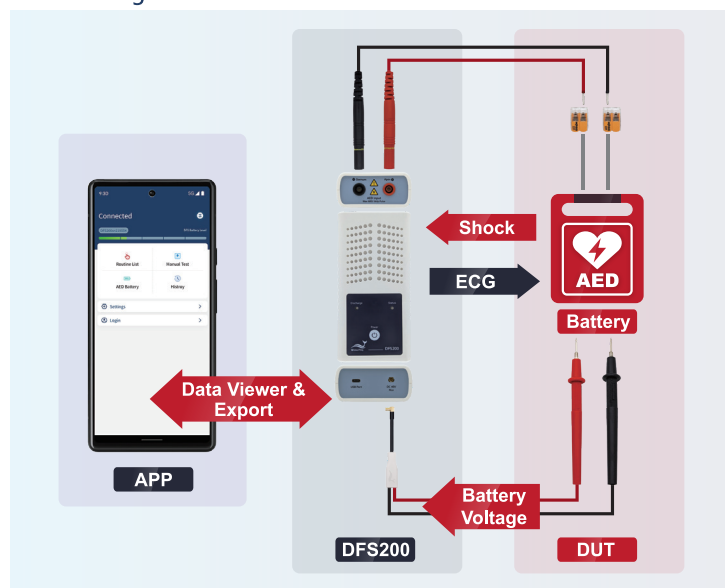

## • Defibrillator Testing Scenario (Optional)



**DFS200**  
Scan for  
more information

[www.whaleteq.com](http://www.whaleteq.com)

[service@whaleteq.com](mailto:service@whaleteq.com)

8F., No. 125 Songjiang Rd., Zhongshan Dist., Taipei City 104474, Taiwan

+886-2-2517-6255

+886-2-2596-0702